

REVISIONS		
REV. NO.	DESCRIPTION	DATE

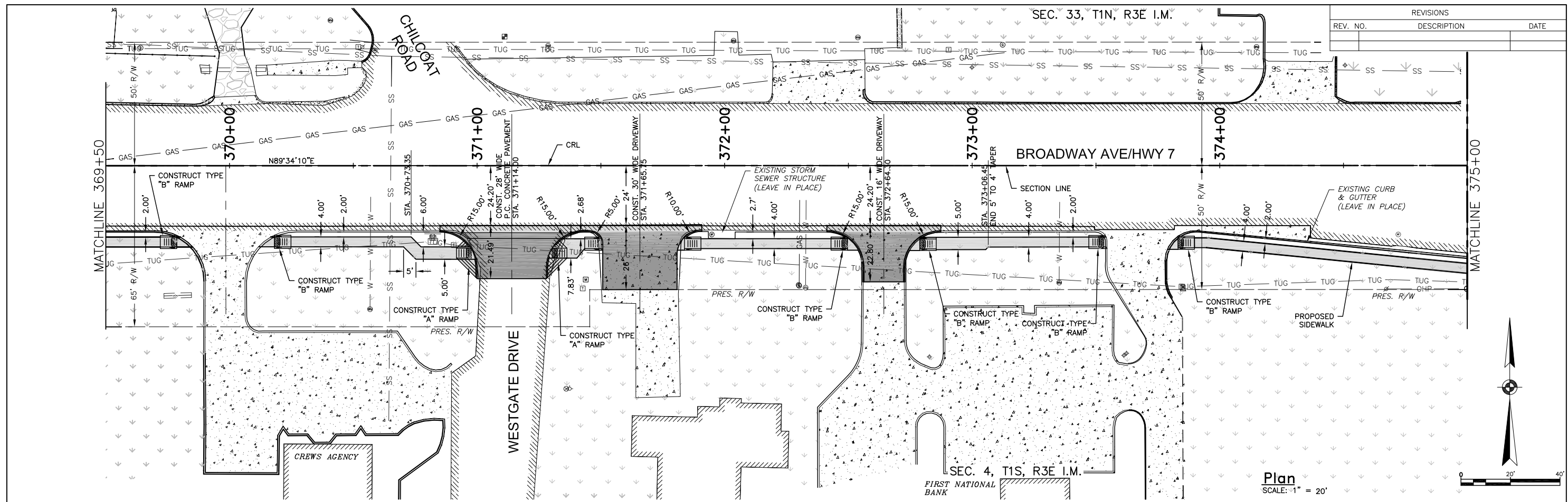

LEGEND																													
	EXIST. ASPHALT		EXIST. GRASS		EXIST. GRAVEL		EXIST. CONCRETE		CLEAN OUT		POWER POLE		GASOLINE FILL CAP		TELEPHONE PEDESTAL		DRAINAGE INLET		SIGN		GAS METER		VENT PIPE		FLAG POLE		LIGHT POLE		WATER VALVE
	BENCH MARK		SANITARY SEWER MH		GAS LINE MARKER		TRAFFIC VAULT		FIRE HYDRANT		SIGNAL VAULT		GUY ANCHOR		WATER METER		STORM SEWER MH		MAIL BOX		YARD HYDRANT		PROPOSED SIDEWALK		PROPOSED CONCRETE				

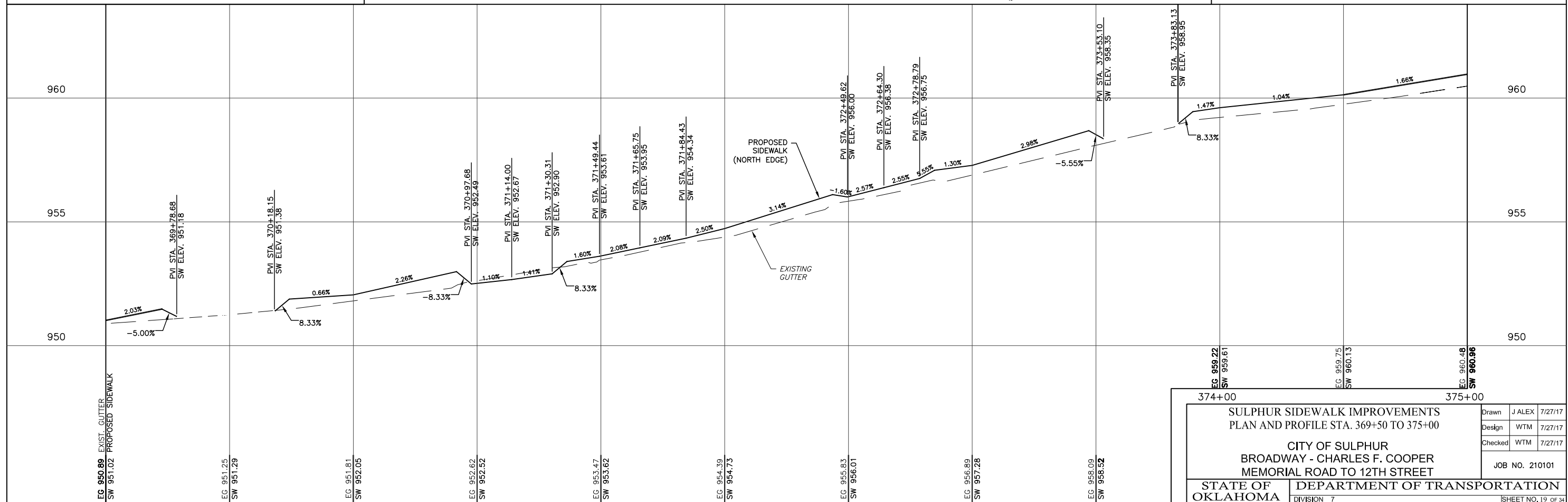

EG 950.89 SW 951.02		EG 951.25 SW 951.29		EG 951.81 SW 952.05		EG 952.62 SW 952.52		EG 953.47 SW 953.62		EG 954.39 SW 954.73		EG 955.83 SW 956.01		EG 956.89 SW 957.28		EG 958.09 SW 958.52		EG 959.22 SW 959.61		EG 959.75 SW 960.13		EG 960.48 SW 960.96	
<p style="text-align: center;">SULPHUR SIDEWALK IMPROVEMENTS PLAN AND PROFILE STA. 369+50 TO 375+00</p> <p style="text-align: center;">CITY OF SULPHUR BROADWAY - CHARLES F. COOPER MEMORIAL ROAD TO 12TH STREET</p> <p style="text-align: center;">STATE OF OKLAHOMA DEPARTMENT OF TRANSPORTATION DIVISION 7</p>																							
<p style="text-align: center;">JOB NO. 210101</p>																		<p>Drawn J ALEX 7/27/17</p>		<p>Design WTM 7/27/17</p>		<p>Checked WTM 7/27/17</p>	
SHEET NO. 19 OF 34																							

J:\Sulphur\210101\cadd\2017\Phase 1\210101_Grading_04.dwg, 8/10/2017 10:16:05 AM, jomA, 1:2:04677